

# KOALA SN 650

## SPECIAL DEVICE

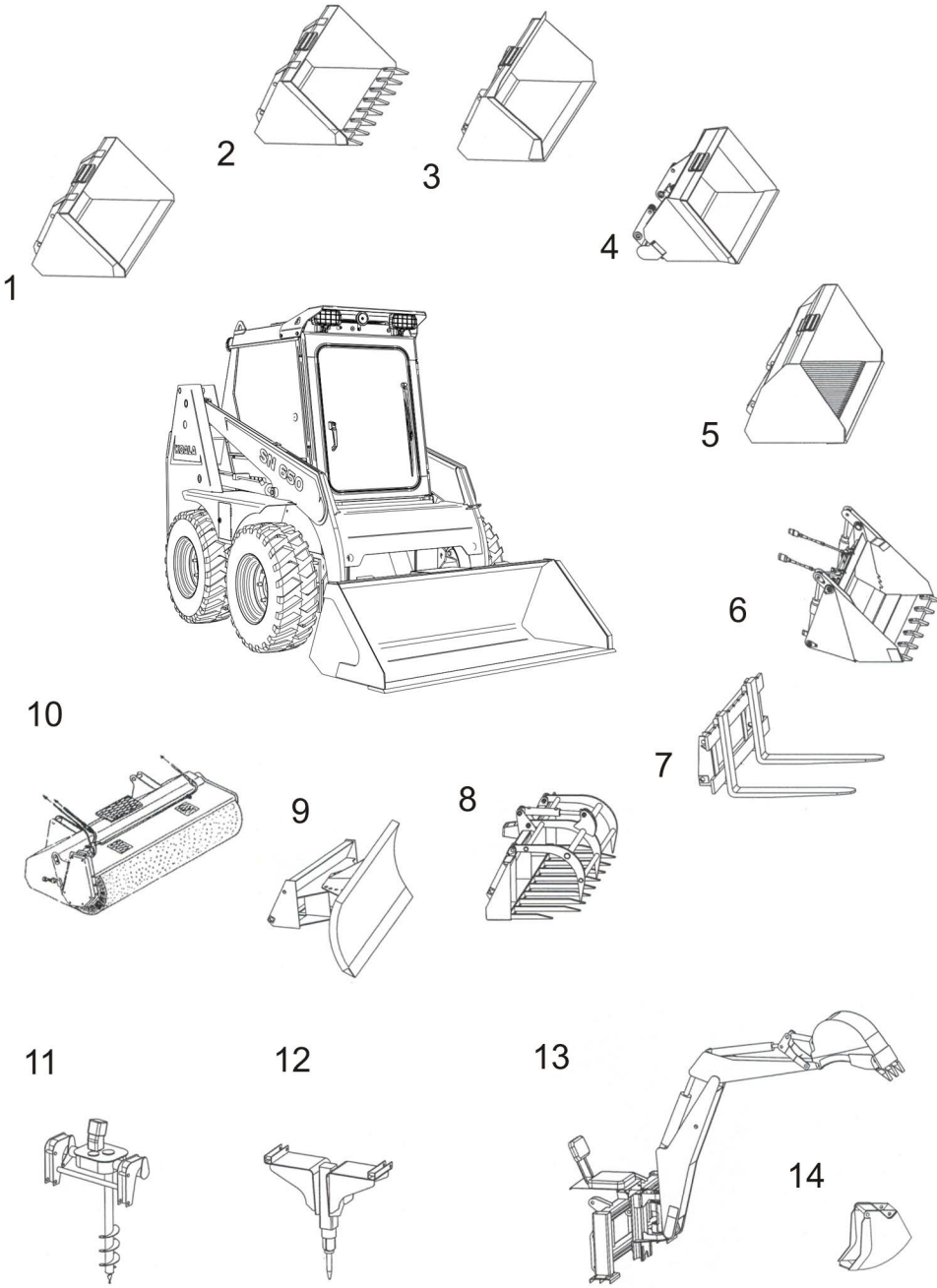

STANDARD EQUIPMENT	
■ ROPS-FOPS tilting cab	■ Automatic action (hydraulic) brakes
■ Adjustable seat	■ Horn
■ Safety belt with function of blocking hydraulic system	■ Accelerator pedal
■ Side windows	■ Auxiliary hydraulic circuit for attachments
■ Front door	■ 12V power supply
■ Rear view mirrors	■ Tyres 10,00/75 - 15.3
■ Two front working lights	■ Universal quick coupler
■ Instrumentation:	■ 1.560 mm bucket with or without teeth
Service hours counter	■ Heating of the cabin
Fuel level indicator	■ Rotating beacon
■ Indicator lights:	
engine pre-heating, charging-up, engine oil pressure, water temperature, hydraulic oil filter, minimum fuel level, parking brake, floating, direction indicators	

OPTIONAL EQUIPMENT	
■ Equipment floating function	■ Rear window wiper
■ Equipment and accessories for running on public communications	■ Additional modular rear counterweight (6 pieces, total weight 126 kg)
■ Windshield washer	■ 2 rear working lights
■ Windshield wiper	■ Back up acoustic warning system
	■ Bucket self-leveling

OTHER OPTIONS	
■ Checking and demonstration of the machine at the supplier	
■ Transport to the customer (price set by agreement)	
■ Lending of a machine for a fixed period	

Place for your dealer:

# KOALA SN 650



# SKID STEER LOADER

■ENGINE POWER  
37.3 kW  
32.8 kW

■OPERATING WEIGHT  
2520 kg

■OPERATING CAPACITY  
650 kg

# KOALA

# KOALA SN 650

**Comfort**

Easy to operate, just two steps to reach the seat, ergonomic situated controls. Cab ensure maximum operating comfort

**Hydraulic servocontrols**

Hydraulic servo-controls make the KOALA SN 650 easy to use with minimum operating effort and maximum movement accuracy of machine and variable attachments.

**Driver's seat**

Driver's seat is lengthwise and height adjustable. Seat suspension is adjustable according to the weight of the driver. Seating part and backrest are made from comfortable and permeable material.

**Cockpit**

Safety cockpit is standardly equipped with front door and side windows. Front door are equipped with wiper and splashers. Heating is as a standard. Tilting cab allows easy access to the engine and hydraulic system.



**Safety**

Wheel base and wheel track assure optional stability and minimal were of tires. This allows safety operation in any terrain. The system of automatic action brakes and safety belt with function of blocking hydraulic system is preventing unwanted running of any function.

**Instrumentation**

All of on/off switches and indication lights are visibly located underneath the roof alongside the driver's seat.

**Quick coupling mechanism**

Quick coupling mechanism allows easy and fast change of wide range of attachments.

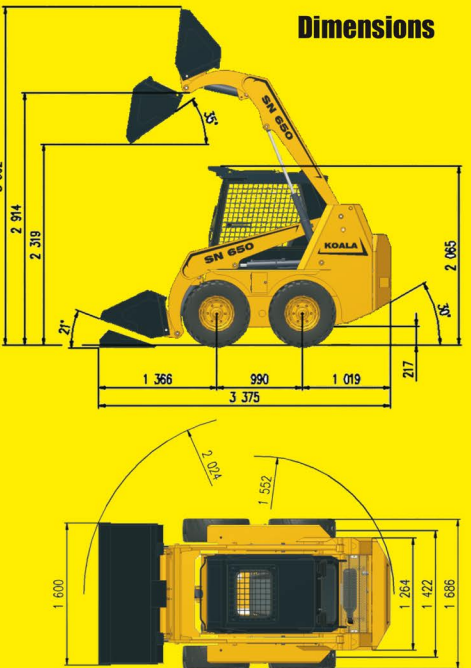

SPECIFICATION	
<b>ENGINE version I</b>	
Model .....	Perkins 404 D - 22
Type .....	4 cylinders, ordinary Diesel
Bore x stroke .....	84 x 100 mm
Combustion .....	Indirect injection
Aspiration.....	Atmospheric
Rated power.....	37,3kW/2800ot/min (ISO/TR 14396)
<b>ENGINE version II</b>	
Model .....	Lombardini LDW 2004 CHD
Type .....	4 cylinders, ordinary Diesel
Bore x stroke .....	88 x 85 mm
Combustion .....	Indirect injection
Aspiration.....	Atmospheric
Rated power.....	32,8kW/2800ot/min (ISO/TR 14396)
<b>OPERATING WEIGHT</b>	
Operating weight of machine with standard bucket, full tank of fuel and a 80 kg operator(ISO 6015) .....	
2530 kg	
<b>HYDRAULIC SYSTEM</b>	
Undercarriage part	
Pump .....	Sauer Sundstrand
Max flow.....	2x 78 l (Dualpistons pump)
Max pressure ..	280 bar
Work part	
Pump .....	Teeth pump
Max flow .....	53l/min
Max pressure ..	180 bar
Control valve.....	3 elements
<b>CONTROLS</b>	
Proportional Servo - controls with help of two cruciate drivers and two foot pedals. Left driver controls left undercarriage and shovel. Right cruciate controls right undercarriage and boom. Left foot pedal controls auxiliary circuit, right foot pedal dieselengine. Safety system stop all operation, if the safety frame in cockpit it will be drawn-up.	
<b>ELECTRIC SYSTEM</b>	
Rated voltage.....	12V
Battery.....	100 Ah
Alternator.....	40 A
<b>UNDERCARRIAGE MACHINE</b>	
Type .....	Hydrostatic
Hydromotors .....	Danfoss(2 x axial pistons)
Drive has chains for hard running, saved in oil spa	
Automatic negative brake	
Rate .....	0 - 12 km/hour
Tyres .....	10.00/75-15.3
<b>REFILLS</b>	
Hydraulic system.....	46 l
Fuel tank .....	55 l
Travencing case .....	2 x 15 l
Engine oil .....	8 l
<b>WORKING PARAMETERS</b>	
Operating load (ISO 5998) .....	650kg
Tipping load (ISO 8313).....	1300kg
Standard bucket capacity (ISO7546) .....	0,35m³
Bucket breakout force (ISO 8313).....	1716 daN (1750kg)
Max lifting capacity (ISO 8313).....	1814 daN (1850 kg)